

Hardware, Track, Sill System & Weathersealing For Exterior Folding Doors

IN A SINGLE DIRECTION:

max panel weight	264 lbs (120 kg) each door.
max panel width	42" (1067 mm).
max panel height	144" (3658 mm).
panel thickness when using E4 sill system	1-3/4" or 2-1/4" (44.45 or 57.15 mm)
max # of panels when using E4 sill system	8 each way
panel thickness when using floor channel	1-3/4" to 3" (44.45 or 76.2 mm)
max # of panels when using floor channel	8 each way

PARTS SELECTION

Eclipse E4™ is specified with 5 separate groups:

1. Track
2. Sill
3. Weathersealing
4. Flushbolts &
5. Hardware

Components are required from all 5 groups to build a folding door system.



Track

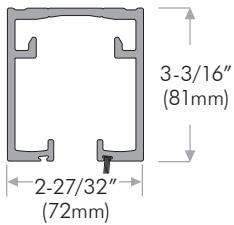

KT80D Top track, extruded aluminum bronze anodized.
Lengths up to 24' - 6" (7.46m)

Sill System

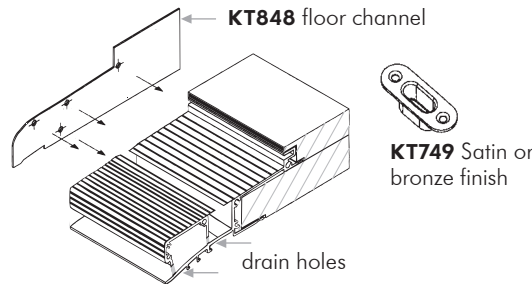

KT841 for 1-3/4" (44mm) door thickness or **KT941** for 2-1/4" (57mm) door thickness. For top water return sill, extruded aluminum bronze anodized.
Lengths up to 24' - 6" (7.46m). Order flushbolt cups and sill assembly end gaskets separately.

Floor Channel

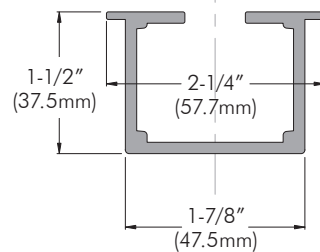

KT18D Floor channel, extruded aluminum bronze anodized.
Lengths up to 24' - 6" (7.46m).

Weatherseals & Astragal



KT427 Weatherseal for sill, jamb and header. Black, brown or white



KT426 Weatherseal for between doors. Black, brown or white



KT369A7545G Aluminum T-slot extrusion with gray pile insert, for top and bottom of doors



KT428B Black weatherseal for between doors, use on clad doors where kerf slot is not possible
KT428W White

KT190 Fir astragal, may be stained or painted



KTP108-35 Pile weatherseal for door with astragal

Flushbolts

4 lengths available:

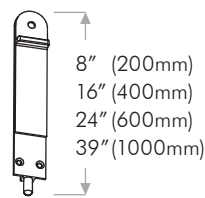

Symphony Style 1" (25.4mm) throw length regardless of bolt length.

Finishes available: brushed aluminum or bronze powder coat.

Hardware

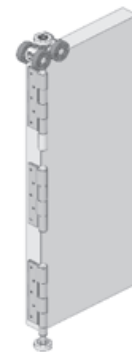

Finishes available: stainless steel (316) or PVD bronze.

NO SCALE